



16335

Interstate Crossroads Building 7

16335 NE Cameron Blvd, Portland, OR 97230

Space for Lease



Building Specs:

Building / Shell Size:	2500 SF
Finished Office:	864 SF
Availability:	Immediate
Price:	\$1695/mo NNN

For more information, contact Three Oaks Development Co.:

Cameron J. Warren Jr.
971-236-9500



J. Timothy Warren
971-236-9500



Interstate Crossroads Building 7

16335 NE Cameron Blvd, Portland, OR 97230

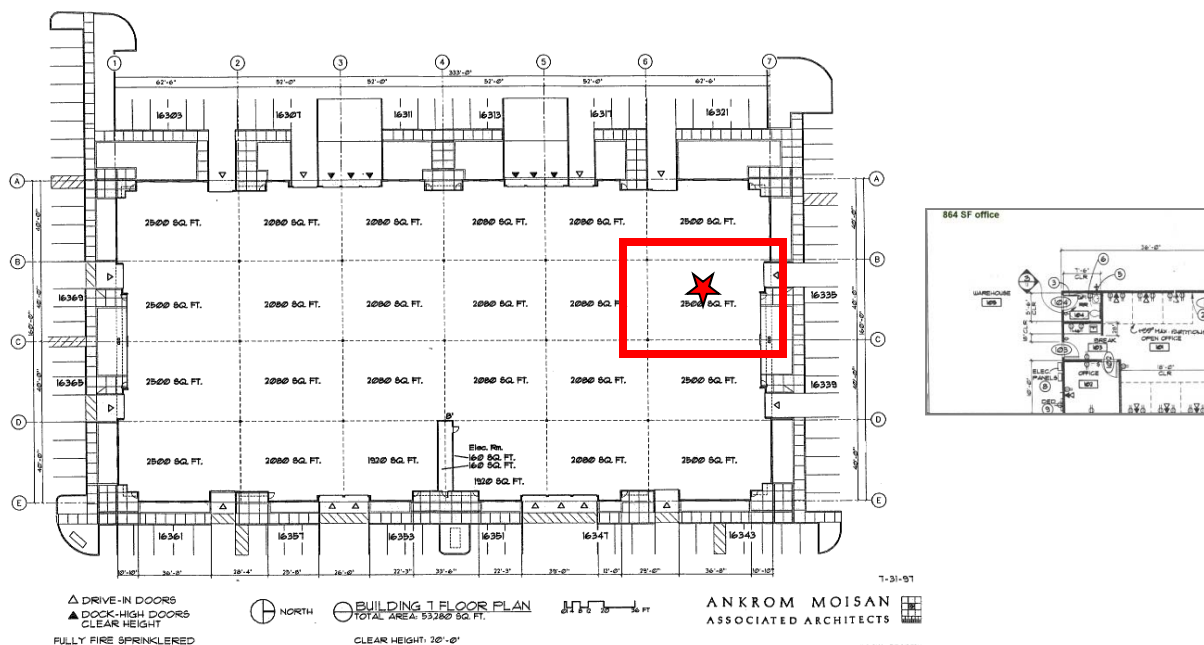

Building 7, 16335 Additional Specs

Clear Height	20'
Loading:	1 Grade Door
Power:	120/208, 200 amp, 3 phase
Additional Amenities:	Network wired, new construction; fire protection

Located just off NE 158th Avenue between NE Airport Way and Marine Drive on NE Cameron Blvd. – just minutes from I-205, I-84 and Portland International Airport.

For more information, contact Three Oaks Development Co.:

Cameron J. Warren Jr.
971-236-9500



J. Timothy Warren
971-236-9500